



LIBRARY PUBLIC SERVICES

Patricia Sotelo



Topics to Be Covered

- Pecan Library Hours
- Extended Hours Commons
- Study Rooms
- Technology Loans
- Library Instruction
- Research Help
- JSTOR AI Research Tool



Pecan Library Hours (F Building)

- Hours:
 - Monday thru Thursday – 7:30 am to 8 pm
 - Friday – 7:30 am to 5 pm
 - Saturday – 10 am to 2 pm
 - Sunday – 2 pm to 6 pm
- First Floor – Collaboration Area
- Second Floor – Study Rooms & Quiet Area
- Second Floor – Silent Study Area



Extended Hours Commons (F134)

- Previously known as Internet Café
 - Monday - Friday 7:00 am - 10:00 pm
 - Saturday/Sunday 7:00 am - 6:00 pm

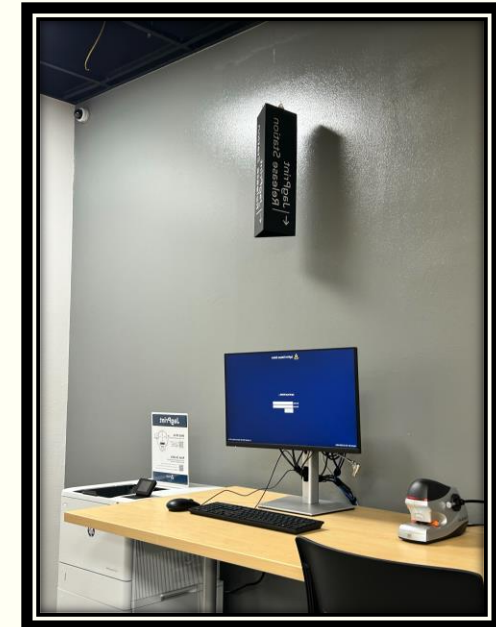
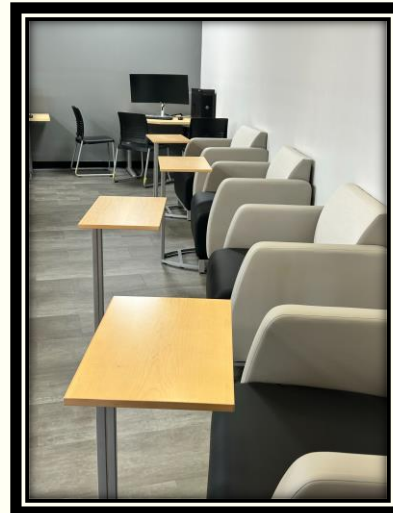

Study Rooms

- 7 upstairs
- 2 downstairs
 - Reserve online
 - Capacity 4
 - One room 6 capacity



- Proposed plan of 7 new downstairs

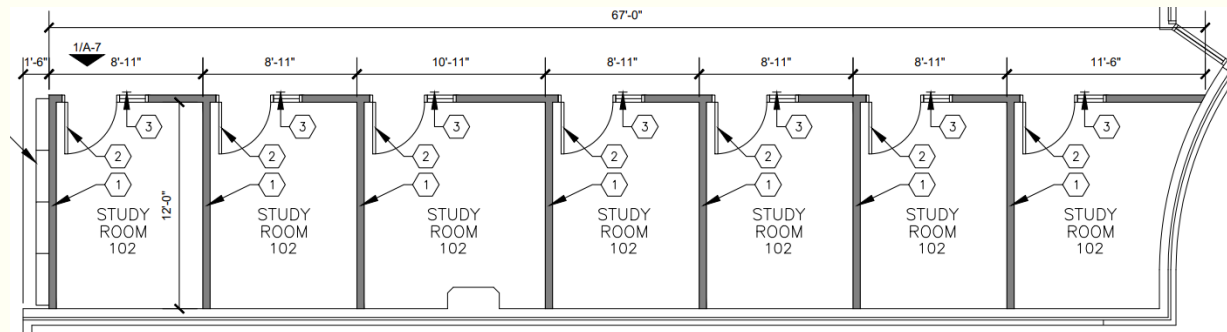

Technology Semester Loans

- Laptops – BAT Laptops – Continuing Ed Laptops
- Hotspots

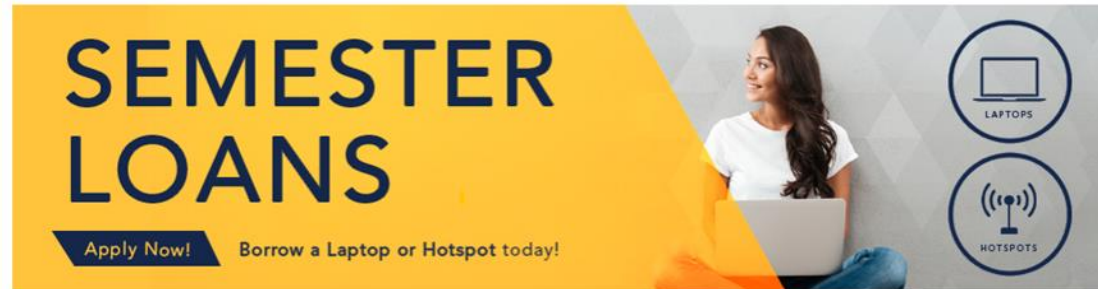

- Calculators
- Cameras
- Digital Engineering Kits
- VR Headsets

Library Instruction

Classroom
Online
High School Campus
F102

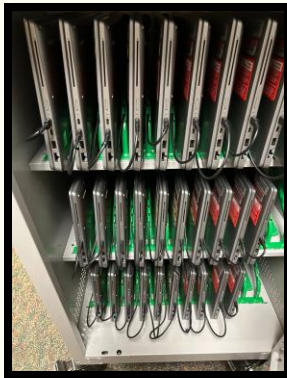

Request Library Instructions:
Email
Teams

Faculty Library Support Portal

Hi, Patricia

Email: psotelo1@southtexascollege.edu

Phone: (956) 872-1609

Dept: Library Public Services

Preferred Contact:

- ☐ Teams
- ☐ Email
- ☐ Phone
- ☐ In-Person

Area(s) of Interest:

- ☒ Library Instruction
- ☐ Collection & OER
- ☐ Course Reserves
- ☐ Purchase Request
- ☐ Interlibrary Loan

Purchase Request and Course Reserves

Faculty Library Support Portal

Hi, Patricia

Email: psotelo1@southtexascollege.edu

Phone: (956) 872-1609

Dept: Library Public Services

Preferred Contact:

☐ Teams

☐ Email

☐ Phone

☐ In-Person

Area(s) of Interest:

☐ Library Instruction

☐ Collection & OER

☒ Course Reserves

☒ Purchase Request

☐ Interlibrary Loan

[Start](#)

<https://library.southtexascollege.edu/faculty/>

Research Help

In-person

24/7 chat

One-to-One Research Help

Research Help

Make a one-on-one appointment with a Pecan Librarian for Research assistance!
This service is currently only available at the Pecan Campus Library, Bldg. F.

Research Help @ Pecan

Full Name *	Patricia Sotelo
Email *	psotelo1@southtexascollege.edu
Course and Section Number (Example: ENGL 1301.KV23) *	<input type="text"/>
Location *	<input type="radio"/> In Person <input type="radio"/> Online
Describe Assignment *	<input type="text"/>

Can I Use AI for This? What Every Student Needs to Know



<https://www.southtexascollege.edu/ai/>

JSTOR AI Research Tool

The **JSTOR AI Research Tool** is a new feature that helps you find and understand information from JSTOR faster. Instead of just typing in keywords, you can ask it questions and it will show you short summaries and helpful articles.

How to use:

- Linked in to South Texas College

- Logged in to JSTOR with their personal accounts

<https://library.southtexascollege.edu/>



Thank You

"The academic library is a partner in teaching, learning, and research—an essential collaborator in student and faculty success."

— *Association of College & Research Libraries (ACRL)*

Contact Information:

Patricia Sotelo - MLS, M.Ed.

Librarian I

psotelo1@southtexascollege.edu

956-872-1609

